

RHINO-RACK

CONTROLLED

Fit Kit for RLT600 RJKB1 to suit Pioneer Tray (PLHS4)

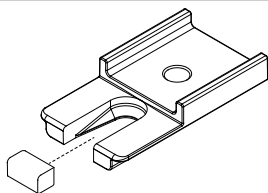

Note:

The end of the leg height spacer M609 must be cut away with a hacksaw for the Front and middle locations.

Parts List

1	Quick Mount Leg HD Bar Spacer	6	M709
2	Quick Mount VA 15mm Spacer	2	M762
3	Pioneer Leg Spacer	4	M609
4	Quick Mount VA 5mm Spacer	2	M760
5	M6 x 45mm Socket Screw	4	B038
6	M6 x 40mm Socket Screw	2	B033
7	RLT600 Flat Base	6	M796
8	M6 Channel Nut	6	N002
9	Instructions	1	R682

Document No: R682

Prepared By: Kayle Everett

Issue No: 05

Authorised By: Chris Murty

Issue Date:31/08/2015

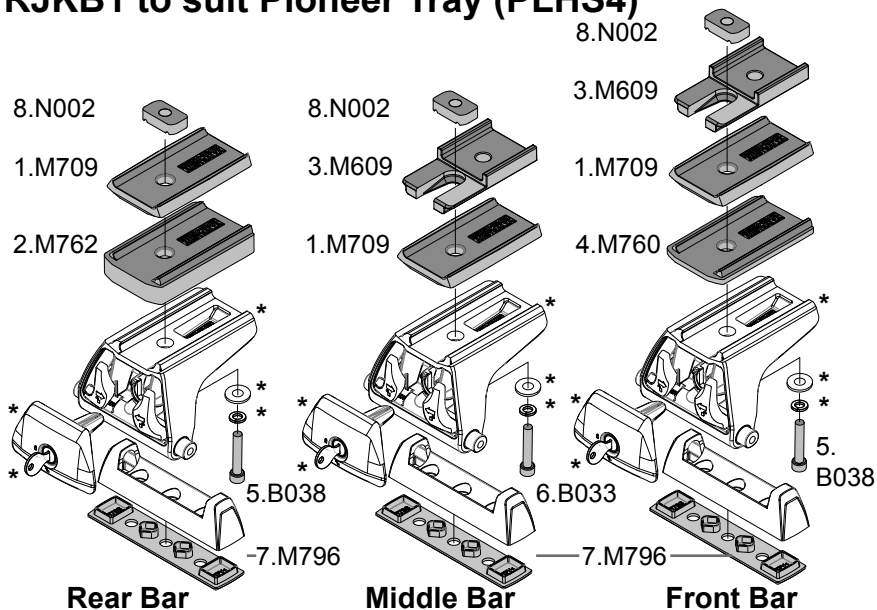

***Note:**

RLT600 Parts as separate.
Fix the Quick Mount Spacer to the Leg using the hardware in the leg kit. The bolts found in the spacer kit will replace the original in the leg kit.

Tools Required:

5mm Allen Key

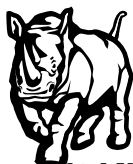
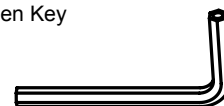

RHINO-RACK

CONTROLLED

Fit Kit for RLT600 RJKB1 to suit Pioneer Tray (PLHS4)

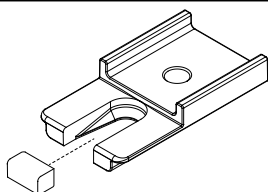

Note:

The end of the leg height spacer M609 must be cut away with a hacksaw for the Front and middle locations.

Parts List

1	Quick Mount Leg HD Bar Spacer	6	M709
2	Quick Mount VA 15mm Spacer	2	M762
3	Pioneer Leg Spacer	4	M609
4	Quick Mount VA 5mm Spacer	2	M760
5	M6 x 45mm Socket Screw	4	B038
6	M6 x 40mm Socket Screw	2	B033
7	RLT600 Flat Base	6	M796
8	M6 Channel Nut	6	N002
9	Instructions	1	R682

Document No: R682

Prepared By: Kayle Everett

Issue No: 05

Authorised By: Chris Murty

Issue Date:31/08/2015

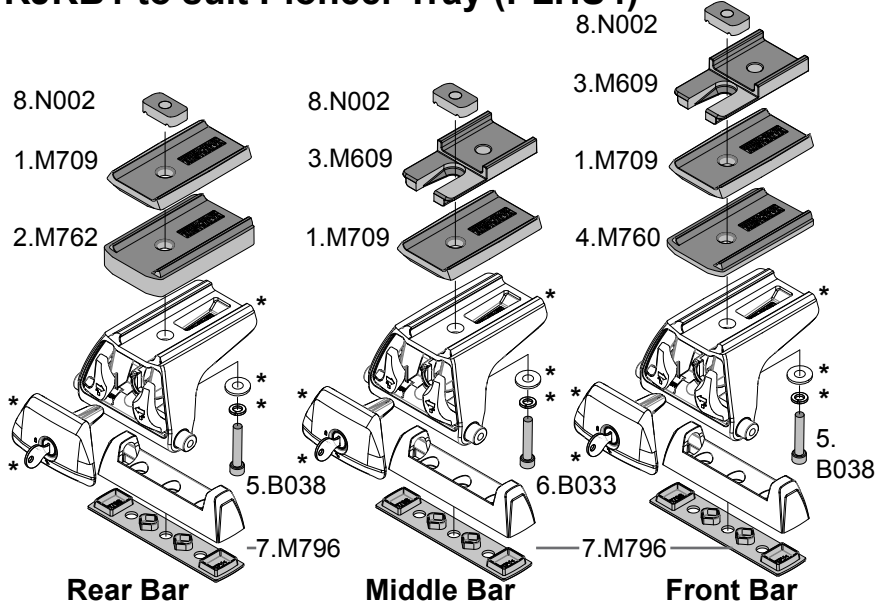

***Note:**

RLT600 Parts as separate.
Fix the Quick Mount Spacer to the Leg using the hardware in the leg kit. The bolts found in the spacer kit will replace the original in the leg kit.

Tools Required:

5mm Allen Key

